

# LED TRACK LIGHT SERIES

## LED TRACKLIGHT

### OVERVIEW

LED economic track light, aluminum lamp body and good heat sink.

Juno or Halo adapter is available.



### FEATURES

#### Body

Aluminum body.

#### LED Characteristics

SMD2835 LED chip ,CRI90, lens beam angel 36°/60°, higher lumen output.

CCT range 2700K/3000K/3500K/4000K/5000K color temperature.

#### Dimming

100%-10% dimming capability. This fixture is compatible with most of LED TRIAC/ELV dimmers.

#### LED Driver

DOB solution (Driver on board) with 120V, 60Hz AC input.

#### Environment

- Suitable for damp locations.
- Approved for direct contact with insulation.

### SPECIFICATIONS

Ordering Model	Size(INCH)	Input Voltage	Freyquency	Watt	Lumen	Color Temperature (5CCT)	Color Rendering Index (CRI)	Beam Angle	Dimmable	Lifetime
TR24D10C	D2.17"×L3.7"×H5.91"	120VAC	60Hz	12W	800lm	27K/30K/35K/40K/50K	>90	36°/60°	Triac	50,000Hrs
TR24D20C	D2.87"×L4.8"×H7.24	120VAC	60Hz	20W	1300lm	27K/30K/35K/40K/50K	>90	36°/60°	Triac	50,000Hrs

### PHOTOMETRIC DIAGRAMS

#### TR24D10C

Input Voltage (VAC)	120
Power Factor	0.89
System Level Power (W)	10
Delivered Lumens (Lm)	885.33
System Efficacy	75.12
Correlated Color Temp (K)	3000
Color Rendering Index (CRI)	90
Beam Angle	46.1

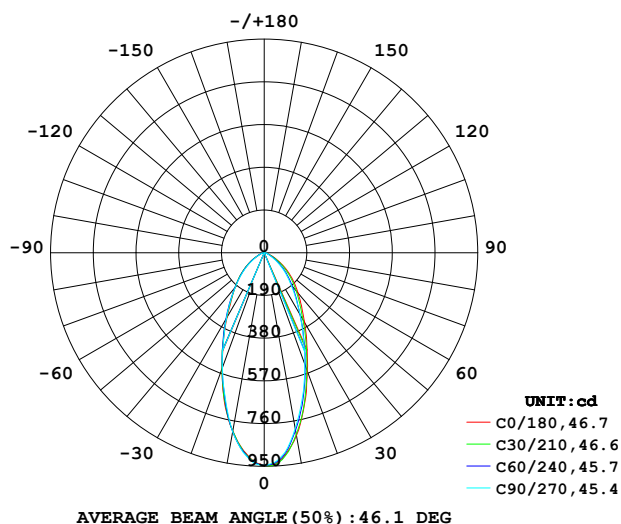

## DIMENSIONS & PACKAGES

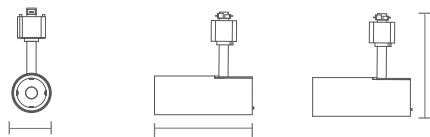

Ordering Model	Outer Diameter	Width	Height	Length (cm)	Outer Carton			Gross Weight (kg)	Container Loading		
					Width (cm)	Height (cm)	Pieces		20ft (26m³)	40ft (64m³)	40HQ (70m³)
TR24D10C	Φ 2.17" (55mm)	3.7" (94mm)	5.91" (150mm)	38	36	26	24	6.78	14400pcs	30720pcs	38400pcs
TR24D20C	Φ 2.87" (73mm)	4.8"(122mm)	7.24" (184mm)	46	43	32	24	10.8	7488pcs	15552pcs	20736pcs

## DIMMING

Dimming Range	10%-100%				
Brand	Model of Compatible Dimmer				
LUTRON	CTCL-153P-BL	S-600P-WH	TGCL-153PH-LA	6B38	
LEVITON	6672-1LW	IPL06-1LZ	DSM10-1LZ	6674	
	6681V/W	6631			

## PACKAGE CONTENTS



1 × Track Light

1 × User Guide

## INSTALLATION GUIDE



**CAUTION:** Turn off the main power at the circuit breaker before installing the fixture, in order to prevent possible shock.

### Electrical Schematic Diagram

**NOTICE:** Dimming performance depends on dimmer, dimmer settings (for dimmers with brightness range adjustments), wiring methods, and the number of led fixtures (Total Power of Lights <80% of the Rated Power of the Dimmer).

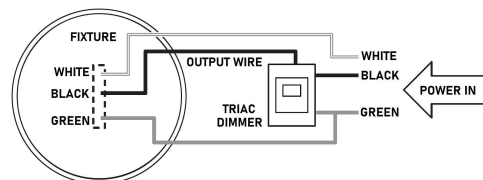

**Installation Steps:** 1. Pull down the locking tap and insert "Adaptor contact " into the slot in the track. 2.Rotate adaptor1/4 turn 90° to locked position.Note:The lamp holder of Grounding tab,polarity side with two pins must point to the track delossed polarity line. 3.SCCCT(27K-30K-35K-40K-50K) selectable on the back side of the track head,you can switch the color temperature as you like,them adjust the angle for you need. 4.If need to remove to other position,depress the locking tap and turn 90°, remove to the position then install.

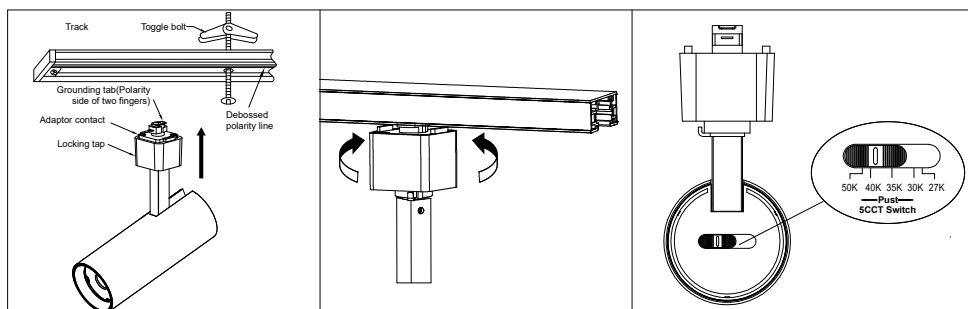

### RISK OF ELECTRIC SHOCK

- All electrical connections must be in accordance with local and National Electric code (N.E.C.) standards.
- Obtains the service of a qualified electrician.

### RISK OF FIRE

- Keep combustibles and other materials that may burn away from lights.
- Do not operate fixture at temperature higher than 104°F.

## ORDERING GUIDE

SLM	Size	Beam angle	Color Temperature	Finish
	2.17"	36°/60°	5CCT : 2700K-3000K-3500K-4000K-5000K	Blank: White
	2.87"	36°/60°	5CCT : 2700K-3000K-3500K-4000K-5000K	BL: Black

## Extra Lighting Manufacturing Limited

Office: Rm1704, Fuli Tianhe Commercial Building, No. 4 Huating Rd, Tianhe District, Guangzhou, 510620 China Tel: 8620 3849 3460

Fax: 8620 3849 3450

Email: market@extra-lighting.com

Website: www.meek-led.com

Factory: No.18 Dongyuan Rd, Yun Pu Street, Huangpu District, Guangzhou, 510700 China Tel: 8620 8252 2583Tel: 86 Fax: 8620 8255 0648