

# LED TRACK LIGHT SERIES



## LED TRACKLIGHT

### OVERVIEW

LED commercial track light, die-casting aluminum lamp body and good heat sink.  
Juno or Halo adapter is available.



### FEATURES

- Body**  
Die-casting aluminum body.
- LED Characteristics**  
COB chip ,CRI90, lens beam angel 15°/24°/36°/60°, higher lumen output.  
CCT range 3000K/4000K/5000K color temperature.
- Dimming**  
100%-10% dimming capability. This fixture is compatible with most of LED TRIAC/ELV dimmers.

- LED Driver**  
UL listed LED driver with 120-277V, 60Hz AC input.
- Environment**
  - Suitable for damp locations.
  - Approved for direct contact with insulation.

### SPECIFICATIONS

Ordering Model	Size	Input Voltage	Freyuency	Watt	Lumen	Efficiency	Color Temperature (CCT)	Color Rendering Index (CRI)	Beam Angle	Dimmable	Lifetime
TR21F10B	Ø55*L138*H146mm	120-277VAC	50-60Hz	10W	750lm	75lm/W	30K/40K/50K	≥90	15°/24°/36°	Triac	30,000Hrs
TR21F20B	Ø60*L158*H151 mm	120-277VAC	50-60Hz	15W	1100lm	73lm/W	30K/40K/50K	≥90	15°/24°/36°	Triac	30,000Hrs
TR21F30B	Ø74*L158 *H155 mm	120-277VAC	50-60Hz	25W	1800lm	72lm/W	30K/40K/50K	≥90	15°/24°/36°	Triac	30,000Hrs

### PHOTOMETRIC DIAGRAMS

#### TR21F30B-3CCT-4000K

Input Voltage (VAC)	230
Power Factor	0.94
System Level Power (W)	25
Delivered Lumens (Lm)	2002.79
System Efficacy	85.44
Correlated Color Temp (K)	4000
Color Rendering Index (CRI)	90
Beam Angle	45.1

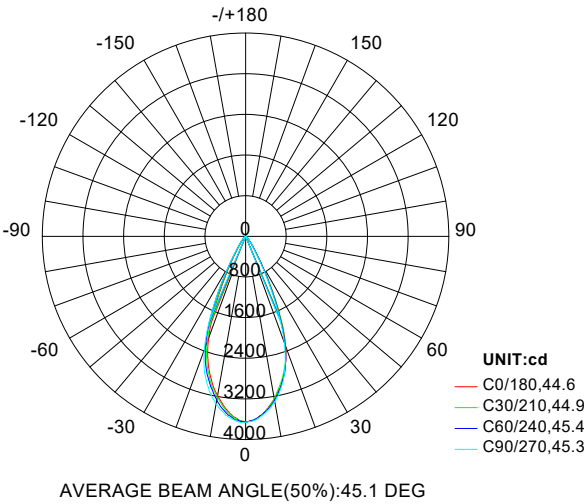

DIMENSIONS & PACKAGES

Ordering Model	Outer Diameter	Width	Height	Length (cm)	Outer Carton			Gross Weight (kg)	Container Loading		
					Width (cm)	Height (cm)	Pieces		20ft (26m³)	40ft (64m³)	40HQ (70m³)
TR21F10B	Φ 2.16" (55mm)	5.47" (138mm)	5.74" (146 mm)	53	28	23	24	7.68	17280pcs	36288pcs	44352pcs
TR21F20B	Φ 2.36" (60mm)	6.22" (158mm)	5.94" (151mm)	53	28	25.5	24	9.84	15360pcs	32256pcs	40320pcs
TR21F30B	Φ 2.91" (74mm)	6.24" (158 mm)	6.12" (155mm)	53	35.5	25.5	24	13.44	12288pcs	25344pcs	31680pcs

DIMMING

Dimming Range	10%-100%			
Brand	Model of Compatible Dimmer			
LUTRON	SCL-153P	CTCL-153PMA	DVCL-153PAY	
	MACL-153P	CL-153M-LA	STCL-153PH-WH	
LEVITON	6674-PO	66672-1L	DW6HD-2RW	IP106-10

PACKAGE CONTENTS

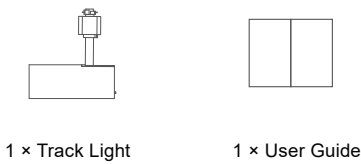

INSTALLATION GUIDE

**CAUTION:** Turn off the main power at the circuit breaker before installing the fixture, in order to prevent possible shock.

Electrical Schematic Diagram

**NOTICE:** Dimming performance depends on dimmer, dimmer settings (for dimmers with brightness range adjustments), wiring methods, and the number of led fixtures (Total Power of Lights <80% of the Rated Power of the Dimmer).

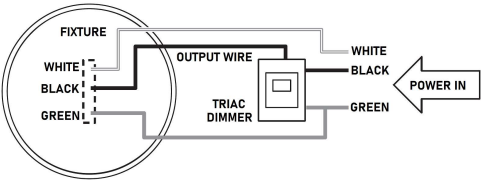

**Installation Steps:**1. Pull down the locking tap and insert "Adaptor contact " into the slot in the track. 2.Rotate adaptor1/4 turn 90° to locked position.Note:The lamp holder of Grounding tab,polarity side with two pins must point to the track delossed polarity line. 3.CCCT(30K-40K-50K)selectable on the back side of the track head,you can switch the color temperature as you like,them adjust the angle for you need. 4.If need to remove to other position,depress the locking tap and turn 90°, remove to the position then install.

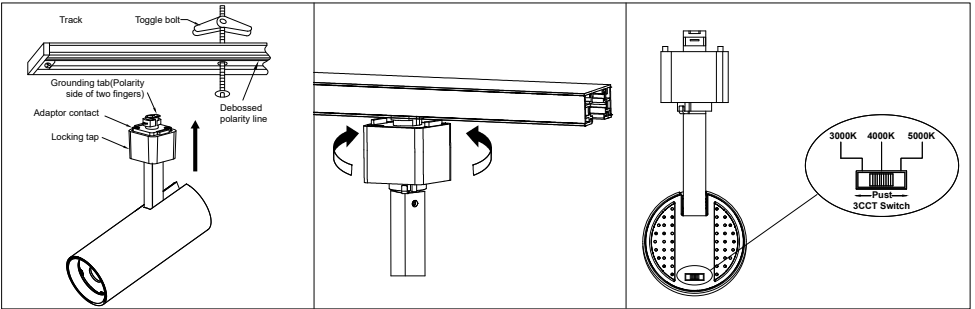

RISK OF ELECTRIC SHOCK

- All electrical connections must be in accordance with local and National Electric code (N.E.C.) standards.
- Obtains the service of a qualified electrician.

RISK OF FIRE

- Keep combustibles and other materials that may burn away from lights.
- Do not operate fixture at temperature higher than 104°F.

ORDERING GUIDE

SLM	Size	Beam angle	Color Temperature	Finish
	2.16"	15°/24°/36°	3CCT : 3000K-4000K-5000K	Blank: White
	2.36"	15°/24°/36°	3CCT : 3000K-4000K-5000K	BL: Black
	2.91"	15°/24°/36°	3CCT : 3000K-4000K-5000K	BN: Brushed Nickel

\* Cable control or unlimited tunable white is available, contact us for more options or OEM /ODM customization.

Extra Lighting Manufacturing Limited

Office: Rm1704, Fuli Tianhe Commercial Building, No. 4 Huating Rd, Tianhe District, Guangzhou, 510620 China Tel: 8620 3849 3460

Fax: 8620 3849 3450

Email: market@extra-lighting.com

Website: www.meek-led.com

Factory: No.18 Dongyuan Rd, Yun Pu Street, Huangpu District, Guangzhou, 510700 China Tel: 8620 8252 2583 Fax: 8620 8255 0648